

Lany Fernandez

From: Claims Assistance
Sent: Monday, 18 July 2022 5:15 PM
To: Ted Besley
Subject: RE: Geospatial assistance request [SEC=OFFICIAL]
Attachments: 20211214_Bigambul_People_Turallin_Property_CAD_A3L.pdf; 20211214_Bigambul_People_Turallin_Property_Description.docx

OFFICIAL

Dear Ted,

Please see attached products prepared December 2021 that possibly suits one of your requests below. Please advise if you would like the name updated to Bigambul People #2 (or #3) and an updated overlap analysis completed.

I anticipate that with current workloads, reworks on the above products could be completed within 1 week.

For the other assistance request, can you provide any additional information as to what the boundaries are to follow e.g. river centrelines (Moonie River?, Condamine River?). I would also suggest we provide the full suite of products that will include a map, written description and overlap analysis.

I anticipate that with current workloads and staffing, the above could be completed in 2 – 3 weeks

Please also note, for future requests for mapping and other assistance, please forward emails to either claimsassistance@nntt.gov.au or luas@nntt.gov.au

I look forward to hearing from you.

Regards

Paul Rowe | Geospatial Services Manager
National Native Title Tribunal | Perth
Level 5, Commonwealth Law Courts, 1 Victoria Avenue, Perth, Western Australia 6000
p. (08) 6317 5433 | e. paul.rowe@nntt.gov.au | w. nntt.gov.au

I acknowledge the traditional custodians of the lands where we live, learn and work.

From: Ted Besley <Ted.Besley@justuslaw.com>
Sent: Friday, 15 July 2022 12:16 PM
To: Enquiries <Enquiries@nntt.gov.au>
Subject: Geospatial assistance request

Caution: This is an external email. DO NOT click links or open attachments unless you recognise the sender and know the content is safe.

Dear NNTT

Our firm has received instructions to file two native title claims on behalf of the Bigambul People.

For the purposes of s 78 of the Native Title Act 1993 (Cth), we require the following assistance from the NNTT's geospatial unit:-

1. A written description of the claim area for Bigambul #2 – see attached plan
2. A written description of the claim area for Bigambul #3 – see attached map.

Feel free to contact me should you require anything further or have any queries.

Kind regards

Ted Besley | Special Counsel
238 Kelvin Grove Road Kelvin Grove Q 4059 | PO Box 120 Red Hill Q 4059
T: 07 3369 7145 | F: 07 3315 2727

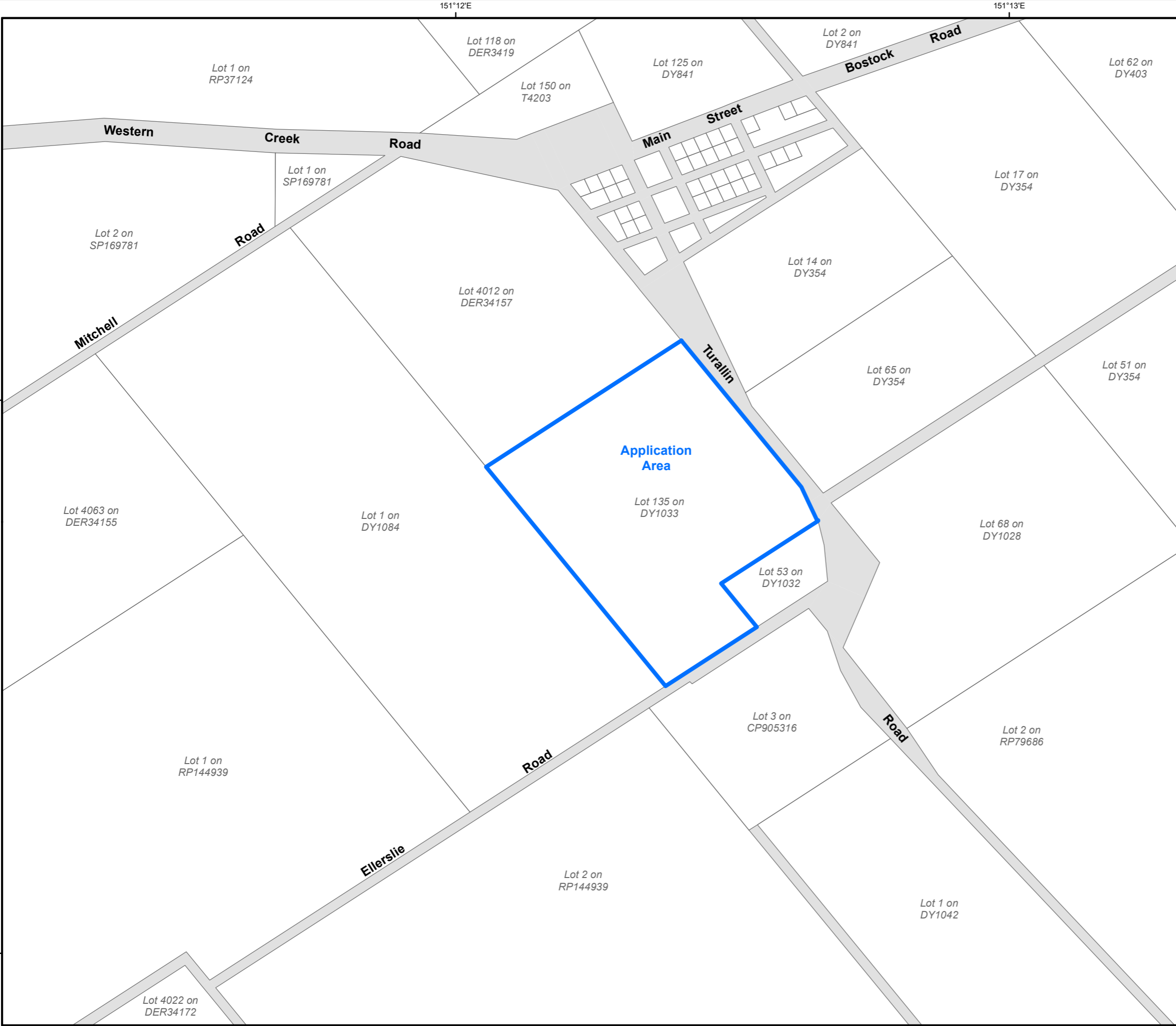

Bigambul People (Turallin Property)

- Application Area
- Cadastral boundary

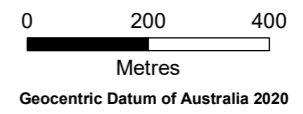

Prepared by:
Geospatial Services, National Native Title Tribunal
14/12/2021

Data Sources:
Application boundary compiled by National Native Title Tribunal based on information or instructions provided by the applicants.
Cadastral data (DCDB) sourced from DoR (QLD), July 2021.

With the exception of the Commonwealth Coat of Arms and where otherwise noted, this map is provided under a Creative Commons Attribution 4.0 International license: <https://creativecommons.org/licenses/by/4.0/>

While the National Native Title Tribunal (NNTT) and the Native Title Registrar (Registrar) have exercised due care in ensuring the accuracy of the information provided, it is provided for general information only and on the understanding that neither the NNTT, the Registrar nor the Commonwealth of Australia is providing professional advice. Appropriate professional advice relevant to your circumstances should be sought rather than relying on the information provided. In addition, you must exercise your own judgment and carefully evaluate the information provided for accuracy, currency, completeness and relevance for the purpose for which it is to be used. The information provided is often supplied by, or based on, data and information from external sources, therefore the NNTT and Registrar cannot guarantee that the information is accurate or up-to-date. The NNTT and Registrar expressly disclaim any liability arising from the use of this information. This information should not be relied upon in relation to any matters associated with cultural heritage.



Bigambul People (Turallin Property)

External boundary description

The application area covers all the land and waters being Lot 135 as shown on DY1033.

Note

Data Reference and source

- Cadastre data sourced from Department of Resources, Qld (July 2021).

Reference datum

Geographical coordinates have been provided by the NNTT Geospatial Services and are referenced to the Geocentric Datum of Australia 2020 (GDA2020), in decimal degrees and are based on the spatial reference data acquired from the various custodians at the time.

Use of Coordinates

Where coordinates are used within the description to represent cadastral or topographical boundaries or the intersection with such, they are intended as a guide only. As an outcome of the custodians of cadastral and topographic data continuously recalculating the geographic position of their data based on improved survey and data maintenance procedures, it is not possible to accurately define such a position other than by detailed ground survey.

Prepared by Geospatial Services, National Native Title Tribunal (14 December 2021)